

Important Notice on Dorm Booking For the 2017 Summer School Students

For the 2017 summer school(from Jul. 2nd to 28th or to Aug.11th) students,

你好! Thank you for choosing our school as your destination for learning Chinese language. For an unexpected reason, we are very sorry to inform you that the dorm booking will go through the e-mail (sushe@sjtu.edu.cn), and we will allocate the dorm according to reply time of your e-mail and your room choice.

I .The apartment types and the room situation are as follow:

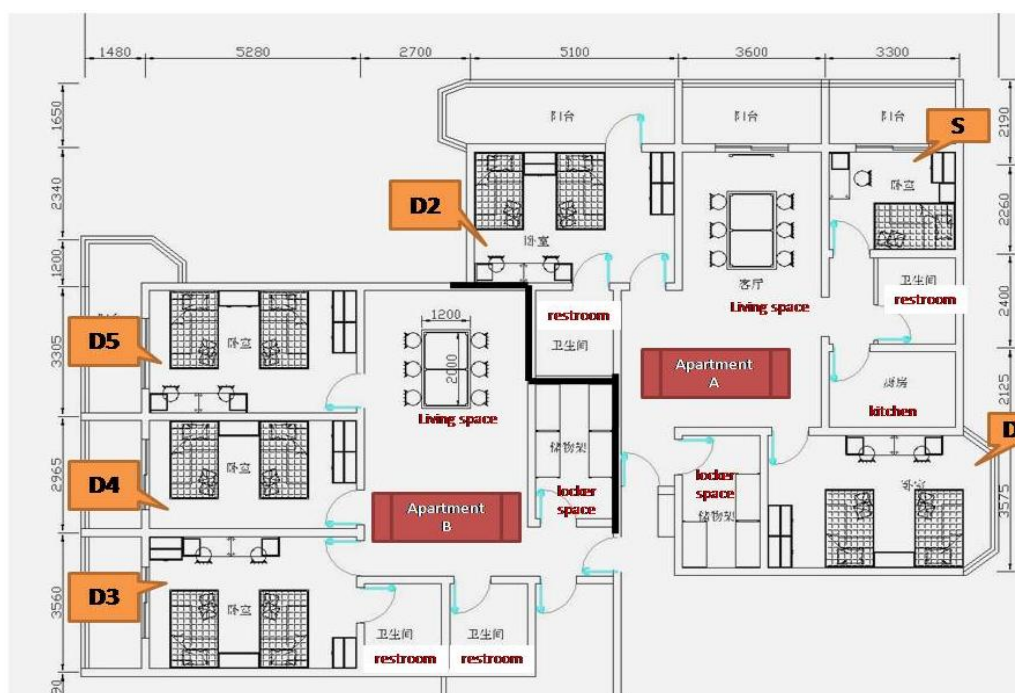

II . Amount of all available beds (S-single room /D-double room):

Room type & price(RMB)	for girls	for boys
S (150/day)	4	2
D1 (100/day)	8	4
D2 (110/day)	8	4
D3 (110/day)	6	6
D4 (100/day)	6	6
D5 (100/day)	6	6
Total	38	28

III.Booking tips:

- 1) Please read the attached two files: *International Student Accommodation Regulations at Panyu Building* and *The Housing Contract for International Students at Panyu Building*. It means that you accept the conditions written in the files once you booked the dorm.
- 2) The booking time is from 0:00 a.m. of June 1st to 24:00 p.m. of June 6th.

3) Please use the format of “**student No.+ Gender**” in the subject of your mail.

4) Please submit your application as the following format (you can copy the form to your e-mail):

the student number (not the online application number)	Gender (M or F)	Room choice (First choice/Second choice/Third choice)	Do you need to keep the bed for 2017 fall term (from Sept.2017 to Jan.2018) ? Yes or No
e.g.2016079012	M	S/D2,3/ D1,4,5/	No

5) We will reply your e-mail to confirm your booking before 24:00 of June 9th. If you don't get the confirmation e-mail from us after 24:00 of June 9th; you have to seek another way to solve the problem of accommodation. If you get the reply; we will tell you how to pay and what you should do for the next step.

6) For more information about the dorm, you can also click the link:
<http://shss.sjtu.edu.cn/Web/Content?w=223&p=70>

Because of the limited resources, some of you may have to find a hotel or an apartment to live.
Thank you for your understanding.

School of Humanities, SJTU
May,2017